

- NOTES (UNLESS OTHERWISE SPECIFIED): (H)
- 1 RECOMMENDED MOUNTING:
#6-32 FASTENER WITH 6.00 IN-LB [7.00 KGF-CM] OF TORQUE MAX.
 - 2 RECOGNIZED TO U.S. AND CANADIAN REQUIREMENTS UNDER THE COMPONENT RECOGNITION PROGRAM OF UNDERWRITERS LABORATORIES, INC.
 - 3 ALL CHARACTERISTICS ARE TAKEN AT THE ACTUATION LINE AND MEASURED FROM THE REFERENCE LINE.
 - 4 FOR MARKING AND NAMING SPECIFICATIONS SEE ES021295.

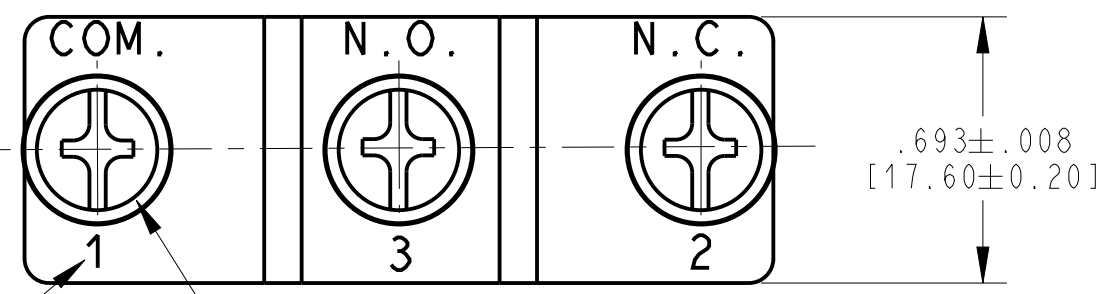

TERMINAL CALL-OUTS MAY ALSO BE LISTED NUMERICALLY

3 - M4 X 4.9 mm
TERMINAL SCREW AND
INTERNAL TOOTHED
LOCK WASHER

CHARACTERISTICS	
ELECTRICAL RATING	15A 250VAC (cULus) T55°C 15A 250V~ (VDE) -5T40
TERMINAL	SCREW
ROLLER	ACUMEN ACETAL F20-03
OPER. FORCE MAX.	160 GMS
RELEASE FORCE MIN.	42 GMS
PRETRAVEL MAX.	.106 [2.7 mm]
OVERTRAVEL MIN.	.094 [2.4 mm]
MOVE. DIFF. MAX.	.019 [0.5 mm]
REST POSITION MAX.	1.280 (32.5 mm)
OPERATING POSITION	1.173 TO 1.205 [29.8 TO 30.6 mm]

DWN: JED	CONFIDENTIAL AND PROPRIETARY: ALL INFORMATION OR INVENTIONS CONTAINED IN THIS DOCUMENT OR DERIVED FROM THE INFORMATION THEREIN IS OWNED BY ZF ELECTRONIC SYSTEMS, AND IS CONFIDENTIAL AND PROPRIETARY. REVIEW OR POSSESSION OF THIS DOCUMENT INDICATES AGREEMENT THAT SUCH INFORMATION AND INVENTIONS WILL NOT BE DISCLOSED, REPRODUCED OR OTHERWISE USED IN ANY WAY WITHOUT EXPRESS WRITTEN PERMISSION FROM AN AUTHORIZED REPRESENTATIVE OF ZF ELECTRONIC SYSTEMS.	ZF Electronic Systems 11200 88th AVE. PLEASANT PRAIRIE, WI 53158 NAME / DESCRIPTION
APVD: SG		
DATE: 21-JUL-04		
THIRD ANGLE PROJECTION		TOLERANCE UNLESS SPECIFIED DWG UNITS X.XX X.XXX ANGLES INCHES ± .02 ± .015 ± 5 °
PROJECT/ CSR	PROJECT/ CSR	C ITEM NO. GPTCRM11
REV ECO NO. DATE PREP APVD	4000000138	SCALE: 2:1 SH 1 OF 1

H	Z000360155	2016-04-25	TLM	ELL
REV	ECO NO.	DATE	PREP	APVD

ORIGINAL ON PRO/E