

DB SUBMINIATURE SWITCH

DB subminiature switch

Precision subminiature switch with high repeat accuracy, available up to an operating temperature of 120°C

- Nominal current up to 10 A at 250 V AC
- A wide variety of auxiliary actuators available
- Actuators can also be retrofitted, two mounting points
- High contact stability due to specific contact materials
- Mechanical life up to 15×10^6 actuations
- Wide variety of terminal types



Technical specifications

Series	DB 1
Contact configuration	S.P.D.T., S.P.S.T. - N.O., S.P.S.T. - N.C.
Contact gap	< 3 mm (μ)
Switching voltage	250 V AC
Switching current	0.1 to 10 A AC, depending on model (see table on page 19)
Operating voltage	70 to 280 cN without auxiliary actuator, depending on model
Total travel	1.6 mm
Mechanical life	see table on page 18
Electrical life	see table on page 18
Ambient temperature	-40 to +85°C/120°C
Proof tracking index	PTI 175 (PTI 250 on request)

Materials

Base	PET (UL 94V-0)
Cover	PBT (UL 94V-0); PET (UL 94V-0)
Actuator	PBT (UL 94V-0) T120 POM (UL 94 HB) T85
Contacts	AgSnO ₂ , AgNi, AuAgPt (Crosspoint)
Terminals	CuZn silver-plated
Auxiliary actuator	Stainless steel or plastic
Approvals	depending on model
Degree of protection	IP50
Switch interior	

Circuitry

Operating temperature +85°C	Code
S.P.S.T. - N.O.	E
S.P.S.T. - N.C.	F
S.P.D.T.	G
Operating temperature +120°C	Code
S.P.S.T. - N.O.	A
S.P.S.T. - N.C.	B
S.P.D.T.	C

Generation of order code (example)

The order code consists of 5 parameters:

1	2	3	4	5
DB	1	C	A1	LB
= subminiature switch	= 6 A, 250 V AC	= S.P.D.T.	= Solder terminal short	= Lever straight, RM rear 4.8

- Not every configurable variant is available for order. Please contact us.
- The final two digits of article numbers on commercial documents refer to the index of the respective drawing.
- Customer-specific models are marked with a G or W as the sixth digit of the article number.

Terminals

Q.C. terminal
2.8 x 0.5 mm

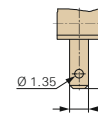

Solder terminal, short

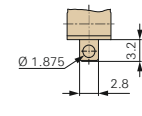

PCB terminal, straight
1.3 x 0.5 mm

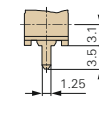

PCB terminal, straight
0.6 x 0.5 mm

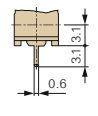

Side definition with terminals and location pins

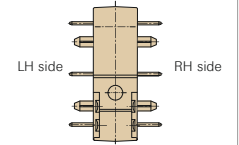

PCB terminal
0.6 x 0.5 mm
RH side w/o location pins

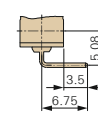

PCB terminal
0.6 x 0.5 mm
LH side w/o location pins

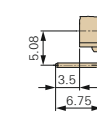

PCB terminal
0.6 x 0.5 mm
RH side with location pins

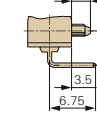

PCB terminal
0.6 x 0.5 mm
LH side with location pins

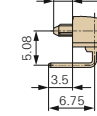

Steel auxiliary actuator

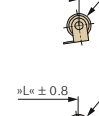
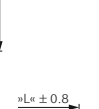
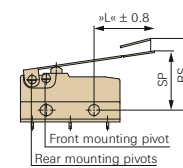

Simulated roller

Auxiliary plastic actuator

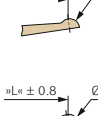
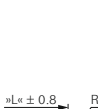
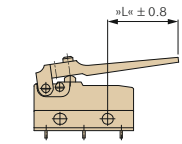

Roller

Drilling patterns

Drilling pattern for PCB terminal 1.3 x 0.5 mm

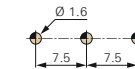

Drilling pattern for PCB terminal 0.6 x 0.5 mm straight/lateral

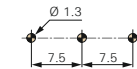

Drilling pattern for PCB terminal 0.6 x 0.5 mm lateral with location pins

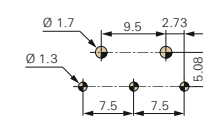

Dimensions in mm