

RECOMMENDED PANEL THICKNESS
.030 TO .049
[0.75mm TO 1.25 mm]

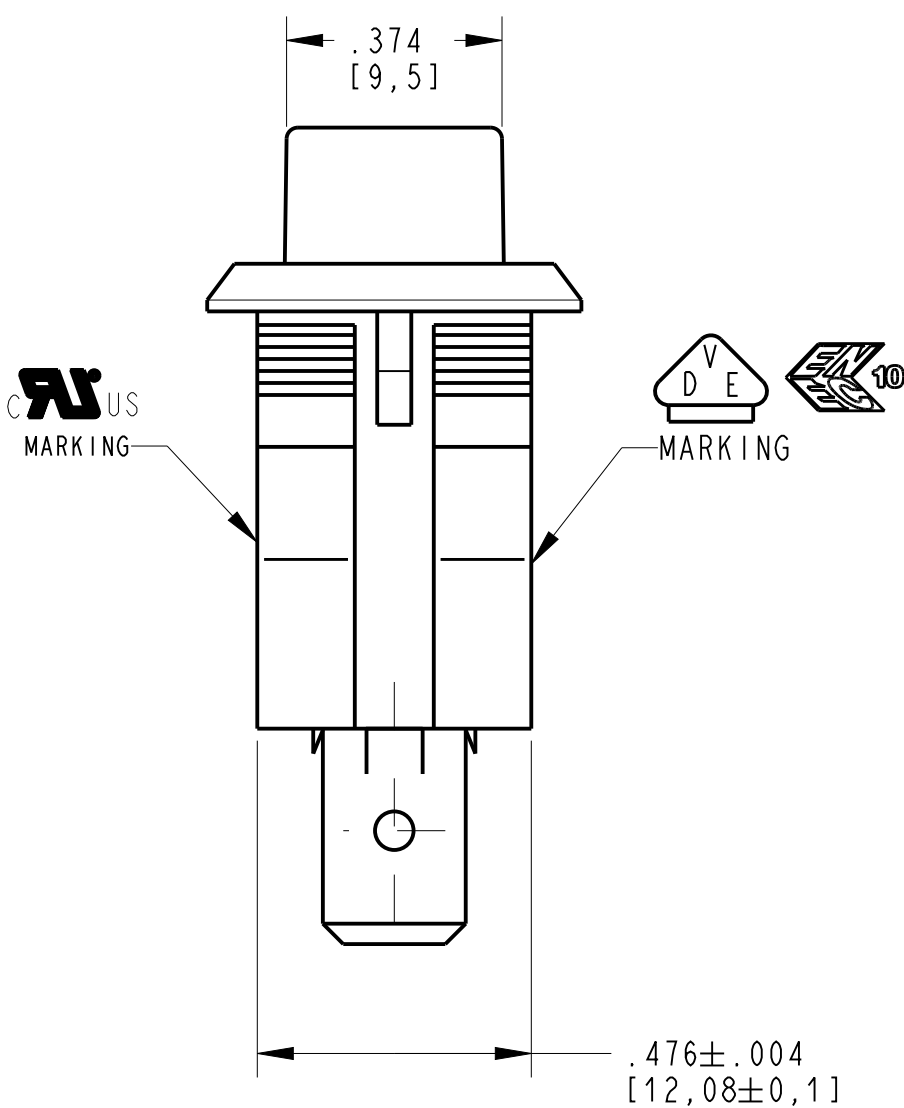
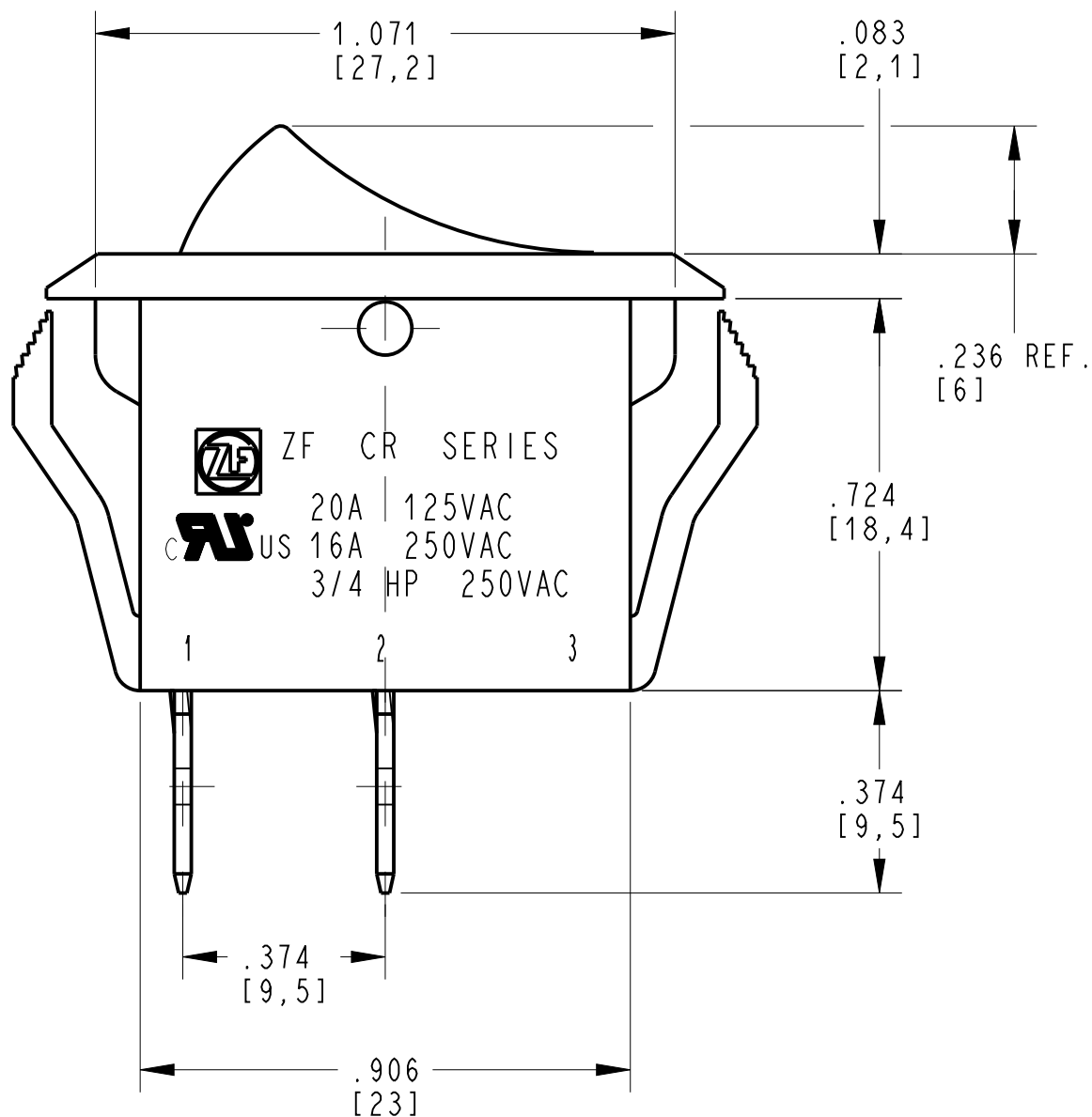
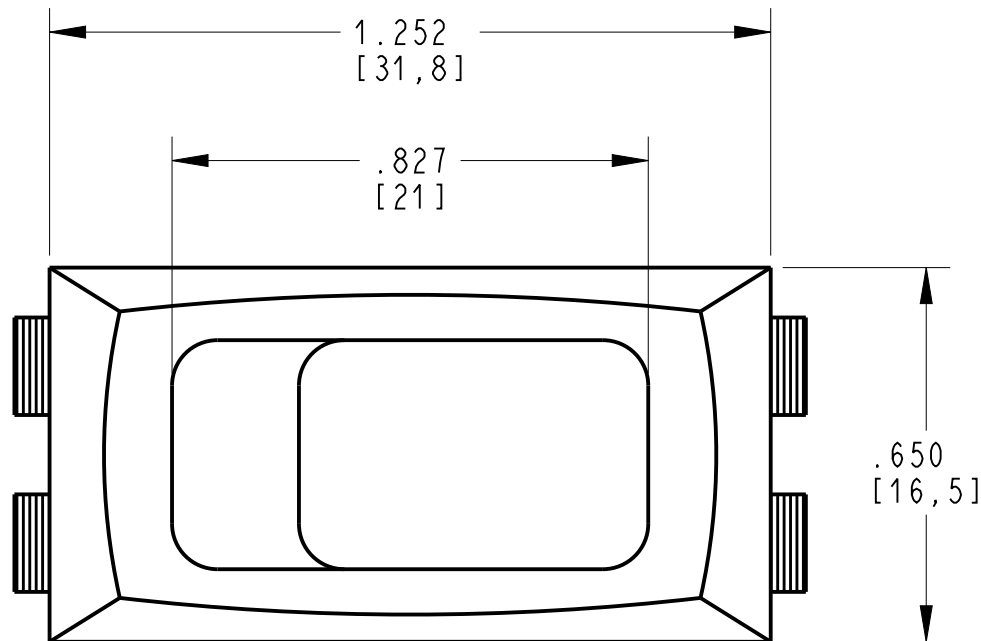

NOTES: (UNLESS OTHERWISE SPECIFIED)

1. RATING TO BE MARKED ON HOUSING
C US 20A 125 VAC
16A, 250 VAC
3/4 HP 250 VAC
V D E 10 16(4)A 250V~ T125/55
2. DIELECTRIC STRENGTH: 1000 VAC FOR 1 MINUTE
3. INSULATION RESISTANCE: 100M Ω MIN. AT 500 VDC.
4. INITIAL CONTACT RESISTANCE: 20m Ω MAX.
5. ELECTRICAL LIFE: 10,000 CYCLES
6. ACTUATOR COLOR: BLACK
HOUSING COLOR: BLACK
7. TERMINALS (3): QUICK CONNECT,
.250 WIDE x .031 THICK
HOLE DIAMETER .067.
8. RECOGNIZED TO U.S. AND CANADIAN REQUIREMENTS UNDER THE
COMPONENT RECOGNITION PROGRAM OF UNDERWRITERS
LABORATORIES, INC.
9. FOR NAMING AND MARKINGS SPECIFICATIONS SEE ES021255.

DWN: F. BURCIAGA
APVD: E. LESLIE
DATE: 12-Jan-11
THIRD ANGLE PROJECTION

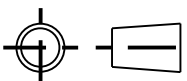

ZF Electronic Systems

11200 88th AVE. PLEASANT PRAIRIE, WI 53158

NAME / DESCRIPTION

SPEC DRAWING

C ITEM NO. CRE22F2BBBNE

SCALE: 3:1 SH 1 OF 1

H	Z000364266	31-Oct-16	JPD	ELL
REV	ECO NO.	DATE	PREP	APVD

TOLERANCE UNLESS SPECIFIED			
PROJECT/ CSR	DWG UNITS	X.XX	X.XXX
4000000138	INCHES	± .02	± .012

ANGLES
± 5.0 °