

NOTES (UNLESS OTHERWISE SPECIFIED):

- \*SWITCH CHARACTERISTICS  
 REST POSITION .551 MAX.  
 PRE-TRAVEL .236 MAX.  
 OPERATING POSITION .315 TO .393  
 OVER TRAVEL .079 MIN.  
 OPERATING FORCE grams 866 MAX.

ALL CHARACTERISTICS ARE TAKEN AT THE ACTUATION LINE AND MEASURED FROM THE REFERENCE LINE

- us** ELECTRICAL RATING  
 16A, 125/250 VAC  
 3/4 HP 125 VAC  
 1-1/2 HP 250 VAC  
 6A, 30 VDC

- E** VDE APPROVED :  
 16(6)A 250 VAC, 25T85, 50E3.

- TERMINALS  
 NO TERMINALS .250 WIDTH x .032 THICKNESS.
- RECOGNIZED TO U.S. AND CANADIAN REQUIREMENTS UNDER THE COMPONENT RECOGNITION PROGRAM OF UNDERWRITERS LABORATORIES, INC.

- TEMPERATURE RANGE -25°C TO +85°C.

- PRETRAVEL & OPER FORCE ARE WHEN BOTH N.O. POLES MAKE.

- us** ELECTRICAL LIFE AT RATED LOAD:  
 100,000 CYCLES MARKED WITH **L**.

1.445<sup>+.005</sup>  
 1.445<sup>-.000</sup> FOR .045 THK. PANEL  
 1.455<sup>+.010</sup>  
 1.455<sup>-.000</sup> FOR .100 THK. PANEL

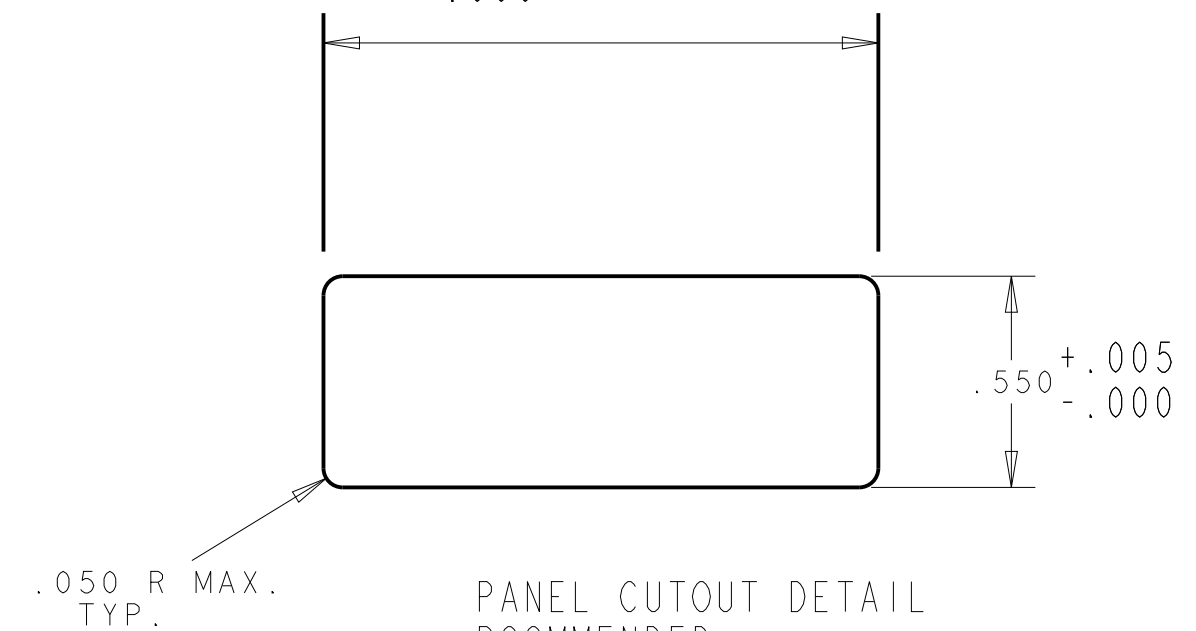

PANEL CUTOUT DETAIL  
 RCOMMENDED  
 PANEL THICKNESS  
 .045-.100

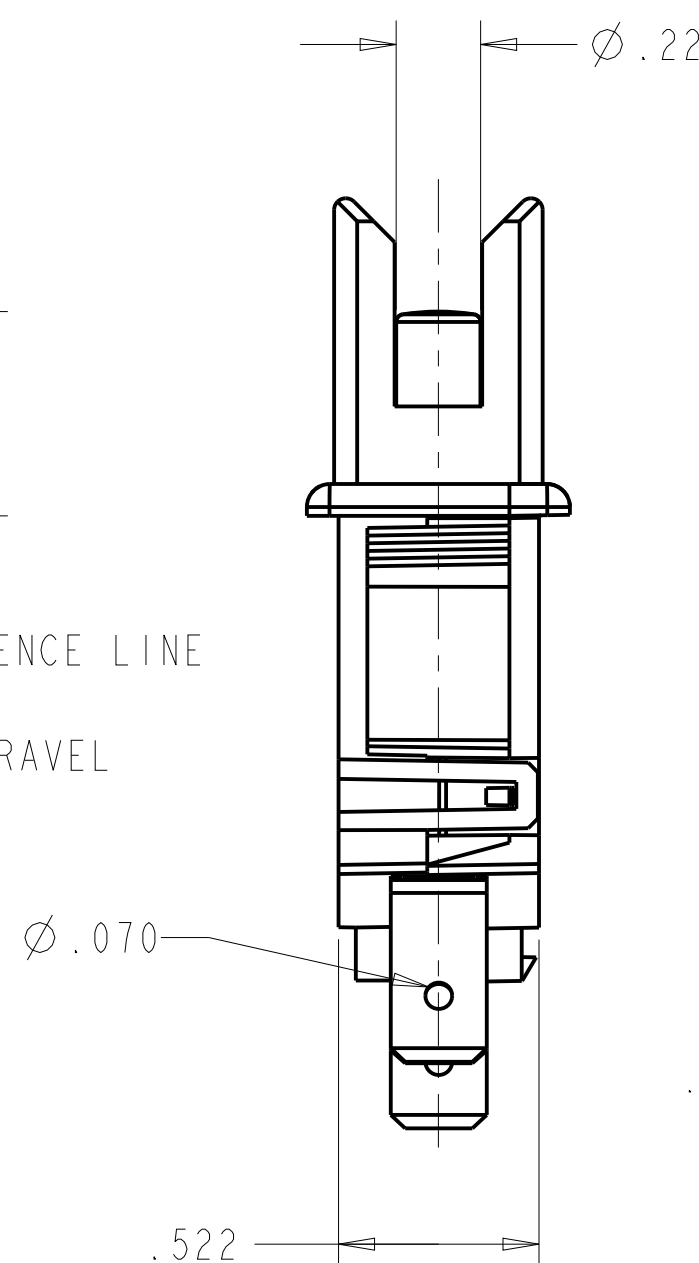
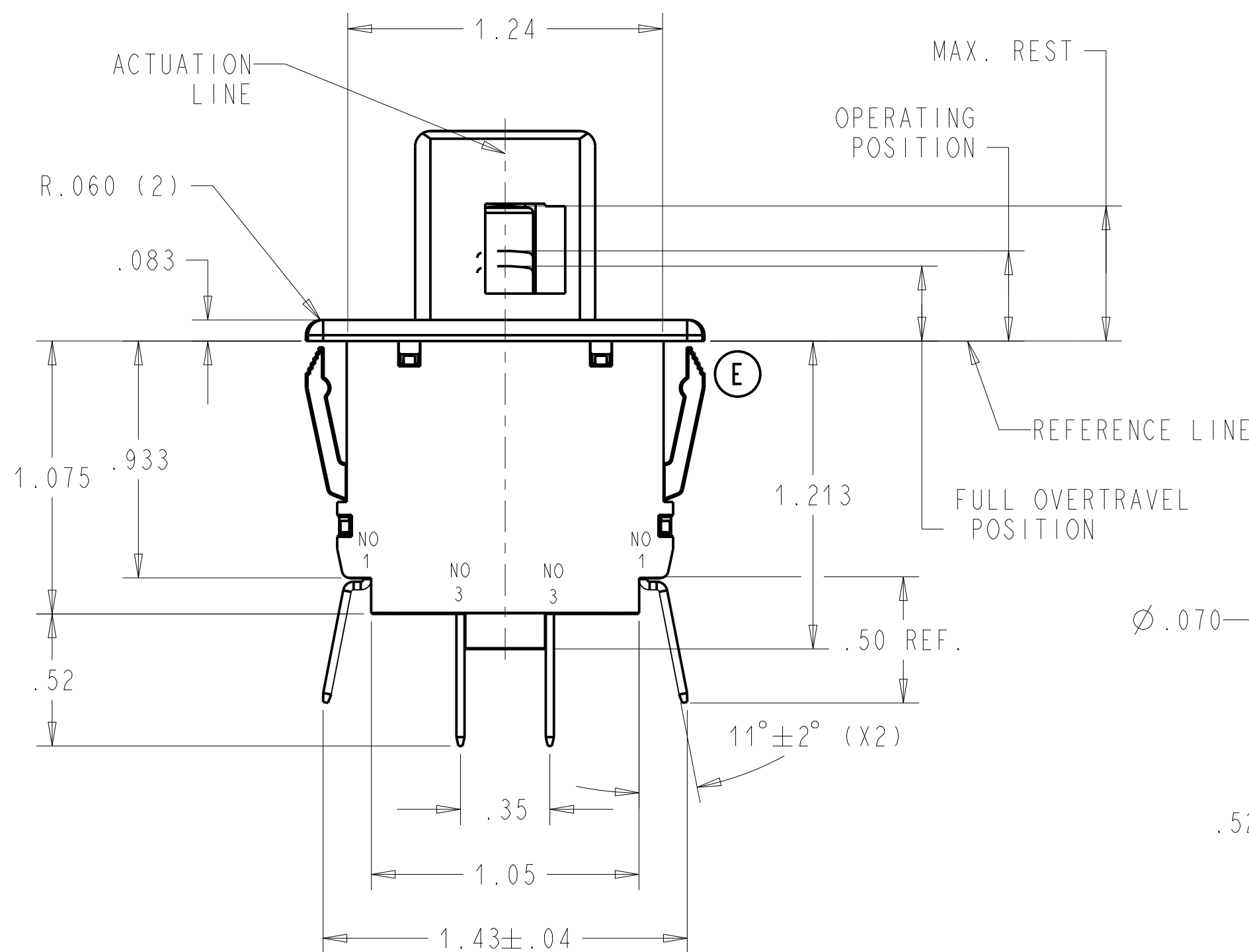

DWN: J. DOLNIK  
 APVD: RC  
 DATE: 19-Feb-04

THIRD ANGLE PROJECTION

CONFIDENTIAL AND PROPRIETARY:  
 ALL INFORMATION OR INVENTIONS CONTAINED IN THIS DOCUMENT OR DERIVED FROM THE INFORMATION THEREIN IS OWNED BY ZF ELECTRONIC SYSTEMS, AND IS CONFIDENTIAL AND PROPRIETARY. REVIEW OR POSSESSION OF THIS DOCUMENT INDICATES AGREEMENT THAT SUCH INFORMATION AND INVENTIONS WILL NOT BE DISCLOSED, REPRODUCED OR OTHERWISE USED IN ANY WAY WITHOUT EXPRESS WRITTEN PERMISSION FROM AN AUTHORIZED REPRESENTATIVE OF ZF ELECTRONIC SYSTEMS.



11200 88th AVE. PLEASANT PRAIRIE, WI 53158

NAME / DESCRIPTION  
**SPEC. DRAWING**

E	Z000377838	12-SEPT-16	TLM	ELL
REV	ECO NO.	DATE	PREP	APVD

PROJECT/ CSR	DWG UNITS	X.XX	X.XXX	ANGLES
4000000138	INCHES	± 0.02	± 0.015	± 5.0 °

C	ITEM NO.	F82A-B120
SCALE:	2.000	SH 1 OF 1

ORIGINAL ON PRO/E