

Panel Mount Pushbutton



Double Pole

E7 F7 series

Features

- Choice of Momentary, Push-Pull (reset) and Cheat Interlock
- Long life coil spring snap action mechanism
- Agency approved extended life versions available
- Snap in mounting
- ENEC available on select models

Standard Parts

0E78-00A0 0E78-30A0 0E78-40A0 0E79-00A0 0E79-30A0 0E79-40A0
 0F79-00A0 0F79-30A0 0F79-66A0

Notes:

Part numbers with a leading 0 and a trailing 0 are functionally no different than without a leading / trailing 0.

Electrical Specifications – Contact Ratings

Switch Series	According to EN61058-1		According to UL1054	
	Nominal Load	Operating Cycles	Nominal Load	Operating cycles
0E75	N/A	N/A	16 A, 125/250 VAC; 1/3 HP; 125/250 VAC	6,000 *
0E77	N/A	N/A	0.1 A 125 VAC; 10 A 1/3 HP, 125/250 VAC	6,000 *
0F77	0.1(0.05) A, 125 VAC; 10(4) A, 250 VAC	50,000		
0E78	N/A	N/A	0.1 A, 125 VAC	6,000*
0F78	0.1(0.05)A, 125 VAC	50,000		
0E79	N/A	N/A	10 A, 125/250 VAC; 1/3 HP, 125/250 VAC	6,000*
0F79	10(4)A, 250 VAC	50,000		

*Extended life UL versions available. Contact factory for more information. Special part number required.

Environmental and Mechanical Specifications

Operating force	680 - 921 grams
Temperature range	-40 °C to 85 °C
Protection class	IP40
Terminal dimensions	Up to 10 A: 4.8 mm x 0.5 mm or 4.8 mm x 0.8 mm; 16 A: 6.3 mm x 0.8 mm

Material Specifications

Case	Thermoplastic Polyester
Actuator button	Thermoplastic Acetal
Terminals	Brass (Common Ag plated)
Moving blade	Beryllium Copper
Spring	Stainless Steel
Contacts	Silver Alloy, Gold Alloy

<https://switches-sensors.zf.com/>

Page 1 of 2, Last update 2025-02-26, Specifications subject to change without notice. In case there are any deviations, the drawing details have priority.



Dimensions (mm) and terminal configurations

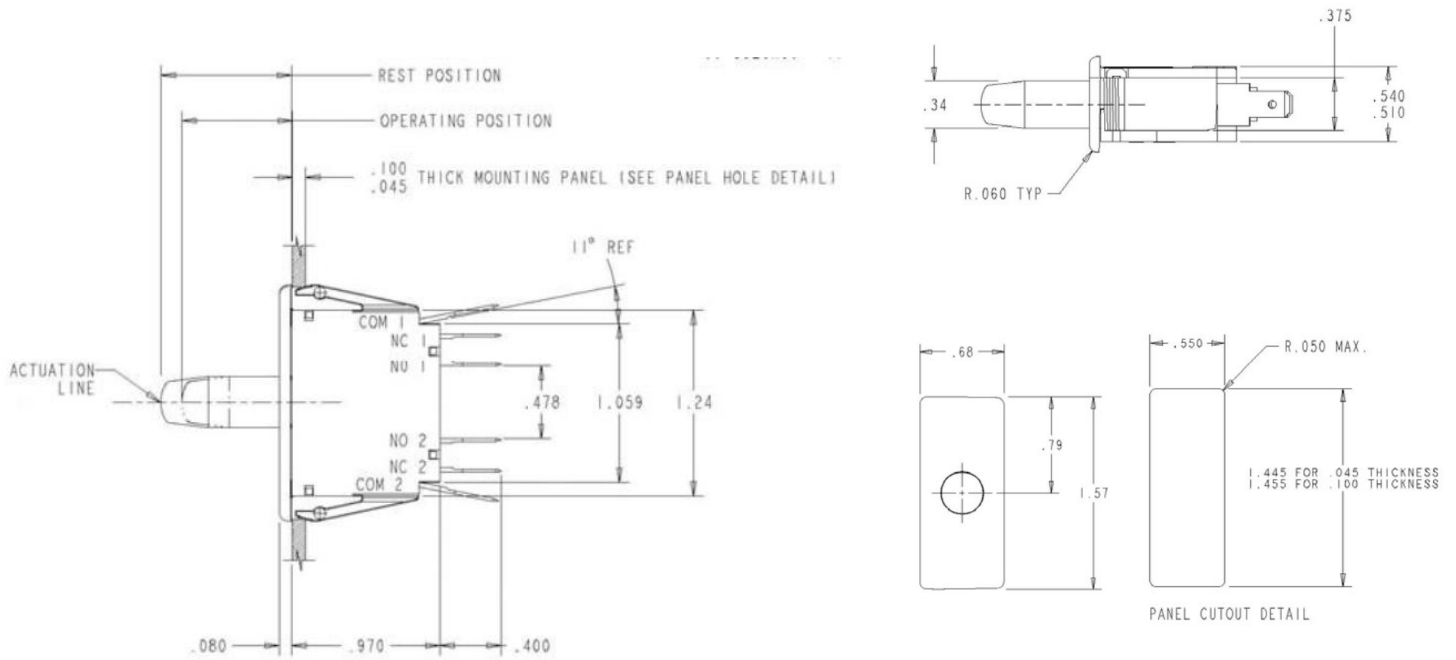

Button details

Actuator (function)

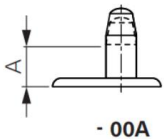

Basic momentary
(Makes contact
while actuated)

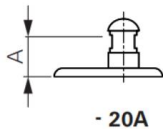

Push-pull (Push:
makes contact, Pull:
reset position)

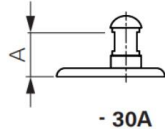

Momentary
(If pushed: normal
pushbutton function)

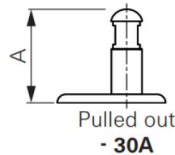

Cheat interlock
(If pulled: permanent
contact function)

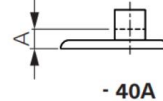

Short button momentary
(Makes contact
while being actuated)

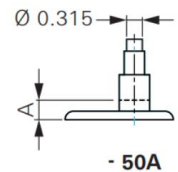

Momentary – for auxiliary
button (Makes contact
while being actuated)