

DR SUB-SUBMINIATURE SWITCH

DR sub-subminiature switch

Available with mushroom or panhead actuator for many actuation possibilities, degree of protection IP40

- Models available up to 105°C operating temperature
- Nominal currents 5 mA up to 2 A at 12 V DC
- Auxiliary actuator on request
- High contact stability thanks to AuAg crosspoint contacts
- Mechanical life min. 1×10^6 operations
- Various connection possibilities



Technical specifications

Series	DR ①
Contact configuration	S.P.D.T.
Contact gap	< 3 mm
Switching voltage (max.)	12 VDC, to 60 V on request
Switching current	0.005 to 2 A DC
Operating force	Max. 75 cN without auxiliary actuator
Total travel	Approx. 2.0 mm
Mechanical life	Min. 1×10^6 operations
Electrical life (max. load)	Min. 100,000 operations
Ambient temperature	-40 to +85°C/105°C

Materials

Base	PBT/PES
Cover	PBT
Actuator	PES/POM
Auxiliary actuator	Stainless steel
Terminals	CuZn silver-plated
Contacts	AuAg (Crosspoint)
Degree of protection	IP40
Switch interior	

Electrical rating ②

Model	Code
0.005 – 2 A DC, 12 V	1

Actuator type ③

Model	Code
Mushroom	P
Panhead	R

Terminal type ④

Terminal type	Code
Solder terminal 2.5 x 0.5 mm, w/o location pins	AN
Solder terminal 2.5 x 0.5 mm, RH side location pins	AR
Solder terminal, straight, 2.5 x 0.5 mm, LH side location pins	AL
PCB terminal, straight, 0.6 x 0.5 mm, w/o location pins	BN
PCB terminal, straight, 0.6 x 0.5 mm, RH side location pins	BR
PCB terminal, straight, 0.6 x 0.5 mm, LH side location pins	BL
PCB terminal RH side, 0.6 x 0.5 mm, RH side location pins	CR
PCB terminal LH side, 0.6 x 0.5 mm, LH side location pins	DL

Auxiliary actuator ⑤

Model	Code
Without auxiliary actuator	A0

Generation of order code (example)

The order code consists of 5 parameters:

①	②	③	④	⑤
Series	Electrical rating	Actuator	Terminal type	Auxiliary actuator
DR = sub-sub-miniature switch	1 = 0.005–2 A DC, 12 V	P = Mushroom	AN = Solder terminal 2.5 x 0.5 w/o location pins	A0 = without auxiliary actuator

- Not every configurable variant is available for order. Please contact us.
- The final two digits of article numbers on commercial documents refer to the index of the respective drawing.

Terminals

Solder terminal
2.5 x 0.5 mm

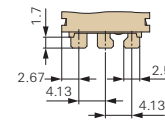

PCB terminal 0.6 x 0.5 mm

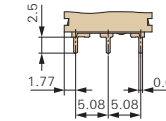

PCB terminal 0.6 x 0.5 mm
RH side with location pins

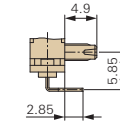

PCB terminal 0.6 x 0.5 mm
LH side with location pins

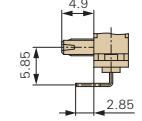

Side definition

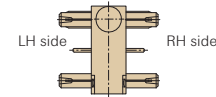

Drilling pattern for PCB terminal
0.6 x 0.5 mm side and underside

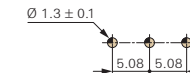

With mushroom actuator

Rest position max. 5.0
Operating point 4.3 ± 0.2
End position min. 2.95

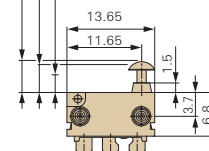

With panhead actuator

Rest position max. 4.2
Operating point 3.5 ± 0.2
End position min. 2.15

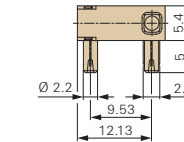
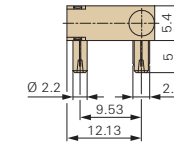
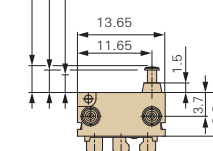

Dimensions in mm

