

DH ULTRAMINIATURE SWITCH

DH ultraminiature switch

- Dimensions only 8.4 mm × 2.7 mm × 6.55 mm
- Designed for low switching currents and voltages
- Available with or without auxiliary actuator
- Solder connection or use lying or standing on a circuit board

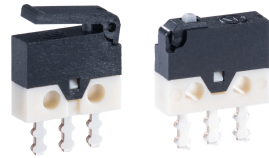

Technical specifications

Series	DH ❶
Contact configuration	S.P.D.T.
Contact gap	< 3 mm
Switching voltage max.	30 VDC
Switching current	5 to 500 mA DC
Operating force	Max. 90 cN
Total travel	Approx. 0.85 mm without auxiliary actuator
Mechanical life	> 50,000 operations
Electrical life (max. load)	> 30,000 operations
Ambient temperature	-25°C to +85°C

Materials

Housing	PPS (UL 94V-0)
Cover	PBT (UL 94V-0)
Auxiliary actuator	PBT (UL 94V-0)
Terminals	CuZn striped silver-plated
Contacts	Au alloy
Degree of protection	IP40
Switch interior	

Electrical rating and operating life ❷

Electrical rating	Operating life			Code
	at nominal load	mechanical		
5-500 mA 30 VDC	30,000	50,000		G

Circuitry ❸

Model	Code
S.P.D.T.	C

Terminal type ❹

Model	Code
Solder terminal, straight, 1.3 x 3.1 mm	B1
Solder terminal, RH side, 1.3 x 3.1 mm	B5
Solder terminal, LH side, 1.3 x 3.1 mm	B4
PCB terminal, straight, 0.64 x 3.1 mm	C4
PCB terminal, RH side, 0.64 x 3.1 mm	C5
PCB terminal, LH side, 0.64 x 3.1 mm	C6

Generation of order code (example)
The order code consists of 5 parameters:

1	2	3	4	5
Series	Electrical rating	Circuitry	Terminal type	Auxiliary actuator
DH = Ultraminiature switch	G = 5-500 mA, 30 V DC	C = S.P.D.T.	B1 = Solder terminal, straight 1.3 x 3.1	LA = with auxiliary actuator

Auxiliary actuator ❺

Auxiliary actuator	Operating force max.(cN)	Max. pretravel (mm)	Max. rest position (mm)	Operating point (mm)	Code
Without auxiliary actuator	90	-	6.2	5.6 ± 0.15	AA
With auxiliary actuator	50	-	8.5	6.7 ± 0.5	LA

Terminals

Solder terminal

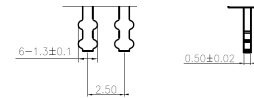

PCB terminal, straight

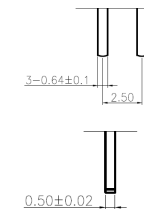

PCB terminal

RH side

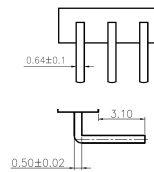

Drilling pattern

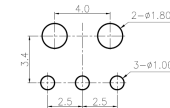

LH side

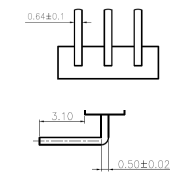

Auxiliary actuator (Plastic)

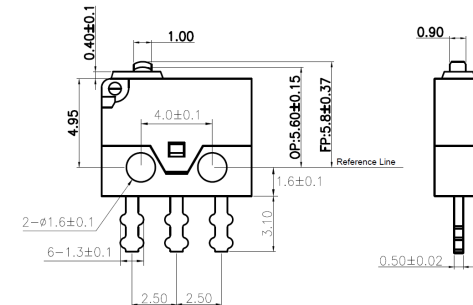
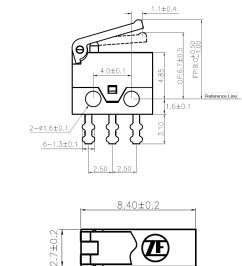

Dimensions in mm