

NOTES: (UNLESS OTHERWISE SPECIFIED)

1. RATING TO BE MARKED ON HOUSING:
20A, 125 VAC
16A, 250 VAC
3/4 HP 250 VAC

16(4)A 250V -T125/55 10E3

2. DIELECTRIC STRENGTH: 1000 VAC FOR 1 MINUTE
3. INSULATION RESISTANCE: 100M Ω MIN. AT 500 VDC.
4. INITIAL CONTACT RESISTANCE: 20m Ω MAX.
5. NEON BULB - COLOR: GREEN
ON-OFF ILLUMINATION:100-125VAC

6. TERMINALS:
.248 \pm .004/- .002; [6.3 \pm 0.1/-0.05] WIDE
.031 \pm .001; [0.8 \pm 0.03] THICK
.067 [1.7] HOLE ϕ
QUICK CONNECTS.

7. RECOGNIZED TO U.S. AND CANADIAN REQUIREMENTS UNDER THE COMPONENT RECOGNITION PROGRAM OF UNDERWRITERS LABORATORIES, INC.

8. FOR NAMING AND MARKINGS SPECIFICATIONS SEE ES021255.

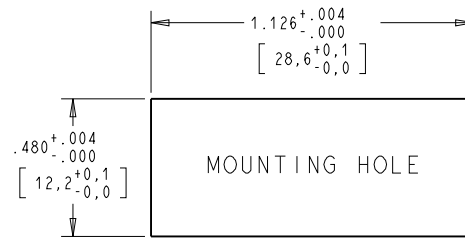

RECOMMENDED PANEL THICKNESS
.030 TO .049
[0.75 TO 1.25]

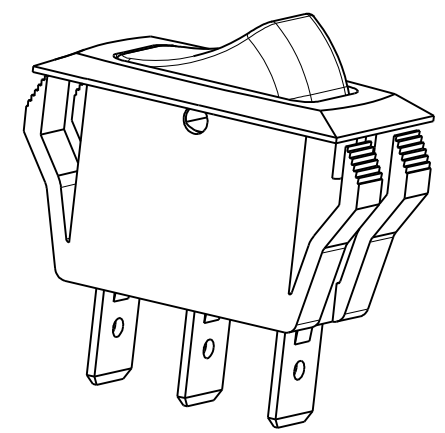
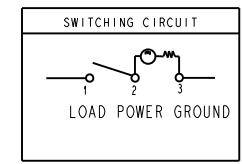
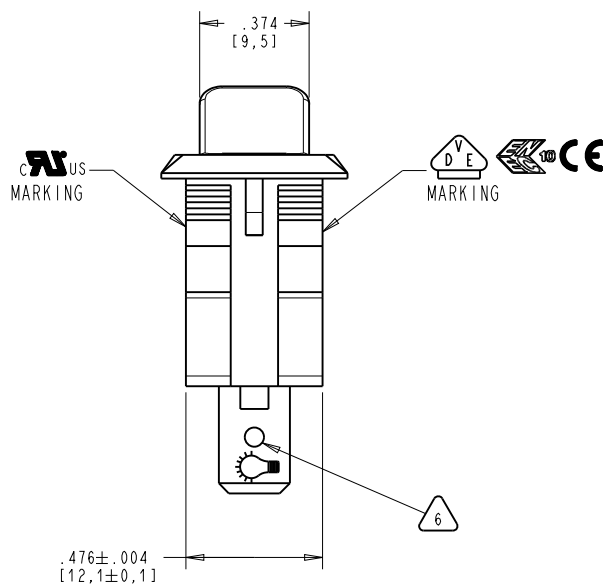
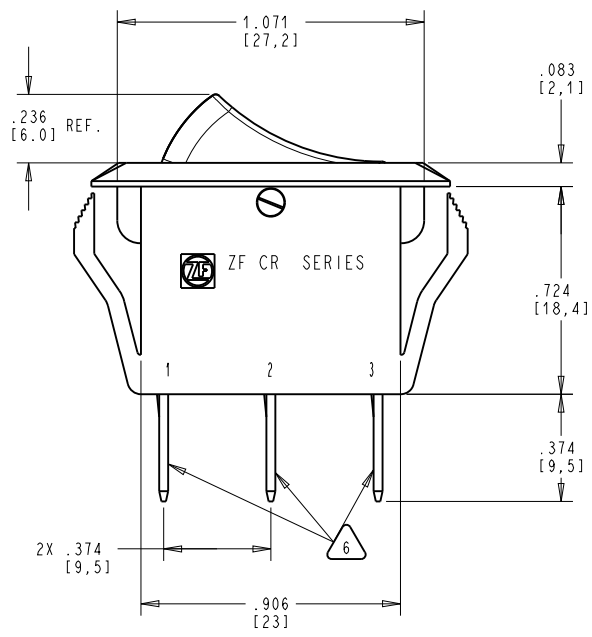
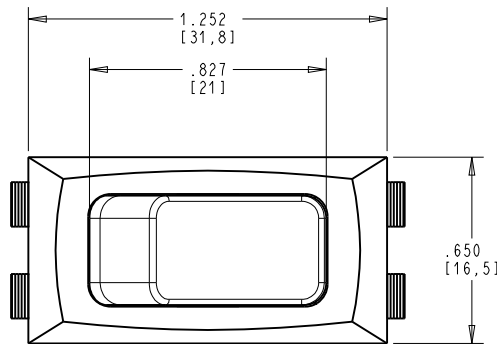

DWN: F.BURCIAGA		CONFIDENTIAL AND PROPRIETARY: ALL INFORMATION OR INVENTIONS CONTAINED IN THIS DOCUMENT OR DERIVED FROM THE INFORMATION THEREIN IS OWNED BY ZF ELECTRONIC SYSTEMS, AND IS CONFIDENTIAL AND PROPRIETARY. REVIEW OR POSSESSION OF THIS DOCUMENT INDICATES AGREEMENT THAT SUCH INFORMATION AND INVENTIONS WILL NOT BE DISCLOSED, REPRODUCED OR OTHERWISE USED IN ANY WAY WITHOUT EXPRESS WRITTEN PERMISSION FROM AN AUTHORIZED REPRESENTATIVE OF ZF ELECTRONIC SYSTEMS.		ZF Electronic Systems	
APVD: E.LESLIE		THIRD ANGLE PROJECTION		PLEASANT PRAIRIE, WISCONSIN U.S.A.	
DATE: 23-Oct-13				NAME / DESCRIPTION	
PROJECT/ CSR		TOLERANCE UNLESS SPECIFIED		SPEC DRAWING	
N/A		DWG UNITS: X.XX X.XXX ANGLES		C ITEM NO. CRE22F2BBGLE	
REV		INCH \pm 0.02 \pm 0.012 \pm 5.0 $^\circ$		SCALE: 3.000 SH 1 OF 1	
J	Z000483810	14-Jan-19	JPD	ELL	
ECO NO.		DATE	PREP	APVD	

ORIGINAL ON PROJ